

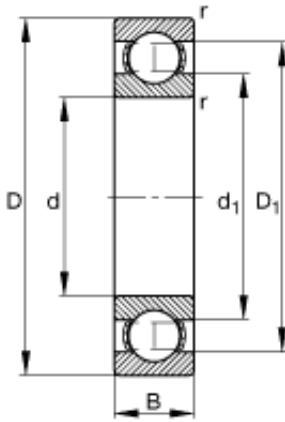

BEARING DE MEXICO, S.A. DE C.V.



45 mm x 68 mm x 12 mm FAG 61909 Single Row Ball Bearings

Bearing No. 61909

61909 Bearing 2D drawings and 3D CAD models

Size	45x68x12 mm
Bore Diameter	45 mm
Outer Diameter	68 mm
Width	12 mm
d	45 mm
D	68 mm
B	12 mm
D_1	60,6 mm
$D_{a \max}$	64,8 mm
d_1	52,4 mm
$d_{a \min}$	48,2 mm
$r_{a \max}$	0,6 mm
r_{\min}	0,6 mm
m	0,135 kg / Weight
C_r	15000 N / Dynamic load rating (radial)
C_{0r}	10900 N / Static load rating (radial)
n_G	14400 1/min / Limiting speed
n_B	8800 1/min / Reference speed
C_{ur}	630 N / Fatigue limit load, radial